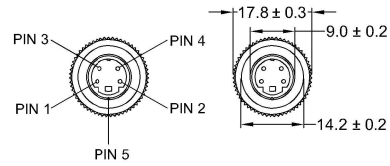

TABLE 1: BE-810XC CAMERA ONLY OPTIONS

PART NO.	MODEL NO.	DESCRIPTION	FIRMWARE VER.
6409	BE-8100C-C	ELITE CAMERA, HEATED, AUDIO, AHD 1080P 25FPS - CAMERA ONLY	MF_A27DP-XXX-MP_REV1.0(210930).IMG
6411	BE-8101C-C	ELITE CAMERA, HEATED, AUDIO, AHD 1080P 30FPS - CAMERA ONLY	MF_A27DN-XXX-MP_REV1.0(210930).IMG

Revision Notes.				
R1 -				
APA: -	Drawn:-	Checked:-	Approved:-	Date: --/--/20--

VIEW A



4 PIN MINI DIN MALE MATING FACE

PIN #	WIRE COLOUR	DESCRIPTION
1	YELLOW	VIDEO
2	RED	+12V
3	BLUE	N.C
4	WHITE	AUDIO
5	BLACK/SHIELD	GND

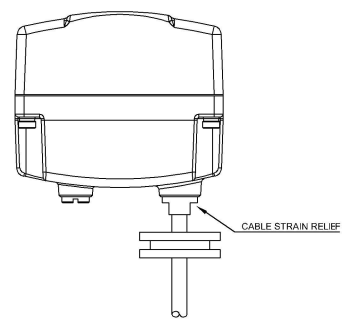
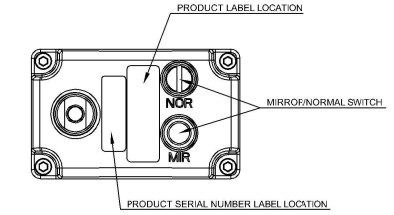
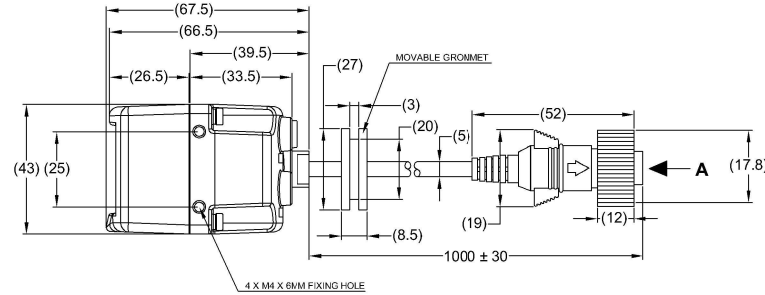
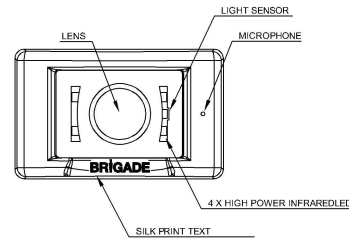
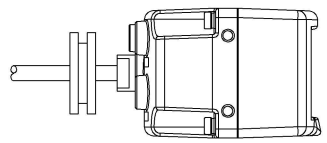
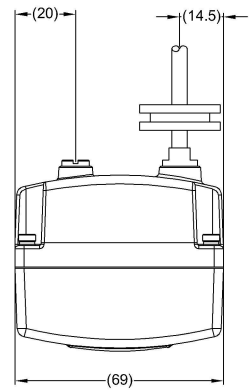

- NOTES:
1. FINISH IS BLACK.
 2. FOR PRODUCT LABEL AND PACKAGING INFORMATION REFER TO MASTER BOM
 3. ANY CUSTOMER MODIFICATION OF THIS PRODUCT CAUSING SUBSEQUENT FAILURE IS NOT A LIABILITY OF BRIGADE ELECTRONICS PLC.
 4. REFER TO TABLE 1 FOR FACTORY INSTALLED FIRMWARE VERSIONS.

PROPRIETARY NOTICE
 THIS DESIGN AND TECHNICAL INFORMATION APPEARING ON THIS DRAWING IS THE PROPERTY OF BRIGADE ELECTRONICS, AND IS DISCLOSED IN CONFIDENCE. IT IS NOT TO BE COPIED, REPRODUCED, REVEALED TO OR EXPROPRIATED BY OTHERS, EITHER IN WHOLE OR IN PART WITHOUT THE EXPRESS WRITTEN CONSENT OF BRIGADE ELECTRONICS.

BRIGADE
 www.brigade-electronics.com

Assembly Pl Approval T. CHOI	Approved by S. LAVER	Checked by S. GOVENDER	Drawn by J. STEWART
<p>Angle of Projection</p> <p>Third Angle</p>	Units mm	Scale N/A	Released 09/03/22
	Status RELEASED	Assembly Ref BE-810XC-C	
Part No SEE TABLE 1	BE-004505-00-21		